

# CORNER RECORD

Document Number 20130066

City of unincorporated area

County of Placer, California

Brief Legal Description Quarter corner common to SEC. 14 & 23, T.11 N., R.7 E., M.D.M. PER 14 R.S. 37

CORNER TYPE		COORDINATES(Optional)		
15	14	Government Corner <input checked="" type="checkbox"/>	Control <input type="checkbox"/>	N. _____
22	23	Meander <input type="checkbox"/>	Property <input type="checkbox"/>	E. _____
T.11 N. R.7 E.		Rancho <input type="checkbox"/>	Other <input type="checkbox"/>	Zone _____ NAD27 <input type="checkbox"/> NAD83 <input type="checkbox"/>
		Date of Survey <u>9/10/2013</u>		NAD83 Epoch _____
				Elev. _____
				Vert. Datum: NGVD29 <input type="checkbox"/> NADV88 <input type="checkbox"/>
				Meas. Units: Metric <input type="checkbox"/> Imperial <input type="checkbox"/>

Corner - Left as found  Found and tagged  Established  Reestablished  Rebuilt

Identification and type of corner found: Evidence used to identify or procedure used to establish or reestablish the corner:  
FOUND 1/4 CORNER SET PER BOOK 14 OF SURVEYS, AT PAGE 37. SET SWING TIES FOR  
THE PURPOSE OF REESTABLISHING THE CORNER AFTER WATERLINE CONSTRUCTION.

A description of the physical condition of the monument as found and as set or reset: FOUND 3-1/2" ALUMINUM DISK IN  
A MONUMENT WELL MARKING THE 1/4 CORNER COMMON TO SECTIONS 14 & 23, T.11 N.,  
R.7 E., M.D.M. SET 1/4" MAG MAIL & 1-1/2" WASHER STAMPED "L.S. 7375" SWING TIES.  
1/4 CORNER WAS SUBSEQUENTLY DESTROYED BY WATERLINE CONSTRUCTION AND  
RESET WITH A 2" BRASS DISK IN A MONUMENT WELL STAMPED AS SHOWN HEREON.

### SURVEYOR'S STATEMENT

This Corner Record was prepared by me or under my direction in conformance with  
the Land Surveyor's Act on SEPTEMBER 12, 2013

Signed John E. Klamm (P.L.S.) or R.C.E. No.: 7375



### COUNTY SURVEYOR'S STATEMENT

This Corner Record was received \_\_\_\_\_ and examined  
and filed SEPTEMBER 18, 2013

Signed Leslie Amberry P.L.S. or R.C.E. No.: 6584

Title Deputy County Surveyor

County Surveyor's Comment \_\_\_\_\_

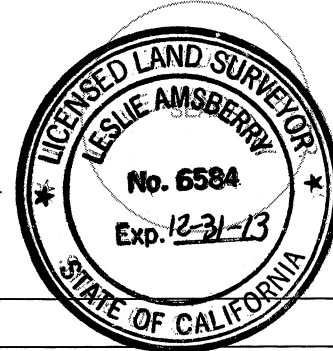

BOOK 14 OF CORNER RECORDS, PAGE 24

BOOK 16 OF CORNER RECORDS, PAGE 26

16 R.S. 128

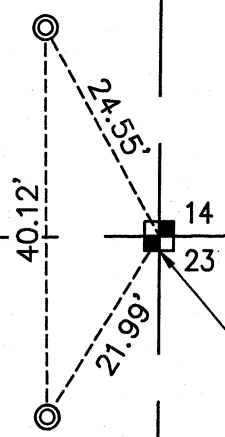

DICK COOK ROAD

ORIGINAL MONUMENT PER 14 R.S. 37 DESTROYED BY WATERLINE CONSTRUCTION & RESET WITH A 2" BRASS DISK IN A MONUMENT WELL STAMPED:

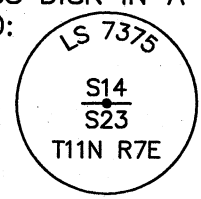

14 R.S. 37

VAL VERDE ROAD



9/12/13

**LEGEND:**

- FOUND ALUMINUM DISK IN MONUMENT WELL STAMPED AS NOTED . . . . .
- SET 1/4" MAG NAIL WITH WASHER STAMPED "L.S. 7375". . . . .

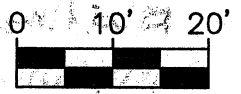
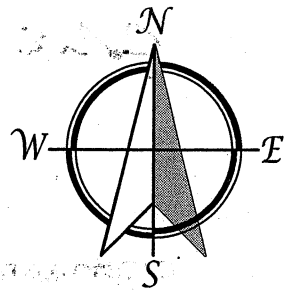

1" = 20'

**CORNER RECORD**  
 REESTABLISHING THE 1/4 CORNER COMMON  
 TO SECTIONS 14 & 23, T.11 N., R.7 E., M.D.M.  
 COUNTY OF PLACER, STATE OF CALIFORNIA

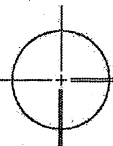
 31 Natoma Street, Suite #160  
 Folsom, CA 95630  
 TEL: 916-608-0707 FAX: 916-608-0701  
**SiteLine Surveying**

SCALE:  
 1"=20'  
 DATE:  
 9/12/2013  
 PAGE  
 2 OF 2