

CORNER RECORD

COUNTY OF PLACER, CALIFORNIA

City of _____ Document Number _____

Brief Legal Description LOT 21, MCKINNEY SHORES SUB. BOOK "G" MAPS, PAGE 25

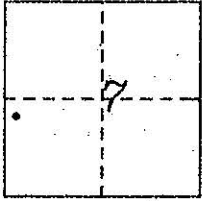

T. 14N., R. 17E
M.D.B. & M.

CORNER TYPE

COORDINATES
(Optional)

Government Corner	<input type="checkbox"/>	Control	<input type="checkbox"/>	N.	_____
Meander	<input type="checkbox"/>	Property	<input checked="" type="checkbox"/>	E.	_____
Rancho	<input type="checkbox"/>	Other	<input type="checkbox"/>	Zone	_____ Datum _____
Date of Survey	<u>NOVEMBER 2005</u>			Elev.	_____

Corner— Left as found Found and tagged Established Reestablished Rebuilt

Identification and type of corner found: Evidence used to identify or procedure used to establish or reestablish corner:

• ~ fd. monument as indicated

A description of the physical condition of the monument as found and as set or reset: _____

Ø ~ set 5/8" rebar with 2" aluminum cap
stamped "TAHOE BASIN LAND SURVEYING,
THOMAS C. BUSWELL, LS 5886". unless otherwise indicated.

SURVEYOR'S STATEMENT

This Corner Record was prepared by me or under my direction in conformance with the Land

Surveyor's Act on December 2005

Signed Thomas C. Buswell L.S. or R.C.E. Number 5886
Thomas C. Buswell, PLS

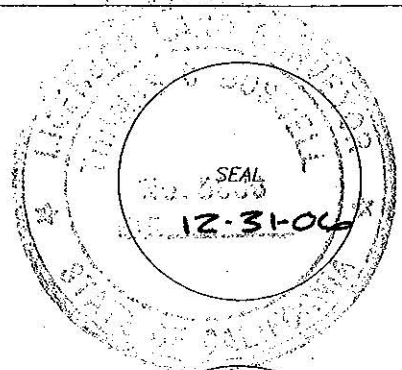

COUNTY SURVEYOR'S STATEMENT

This Corner Record was Received _____ 20 _____ and Examined

and filed Nov 7 2006

Signed Charles B. Grant Title DEPUTY COUNTY
LS 6158 SURVEYOR

County Surveyor's Comment _____

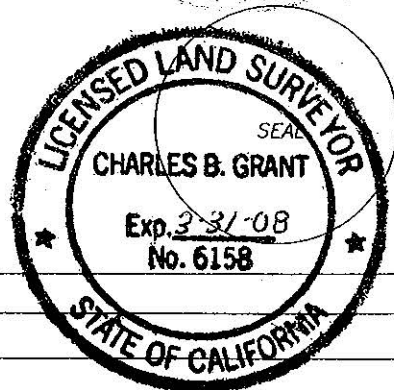

BOOK 10 CORNER RECORDS PAGE 69

Mckinney Drive 50' r.o.w.

fd. 5/8" bar with 2" aluminum cap stamped Tahoe Basin Land Surveying Thomas C. Buswell, LS 5886 @ N.E. corner Lot 27

ESTABLISHED AT RECORD set nail and tag in epoxy in small boulder

fd. 1/2" bar, no tag (R1) @ S.W. corner Lot 19 SAME POINT
 BASIS OF BEARINGS
 S 86°51'29"W (C)(R1)
 815.59'(815.45')(C)(R1)

Lot 19
 (N 65°41'02.5"W)(R1)
 (N 65°38'44"W)(R1)
 (122.22')(R1)
 (122.16')(R1)

Lot 20
 fd. 1/2" bar, no tag (R1)
 BASIS FOR PRORATE

Lot 21
 Parcel Area 14,490 s.f.

Lot 22
 N 02°33'10"E (R1)
 (155.8')(R1)
 (137.70')(R1)
 (137.86')
 S 09°40'29"W (R1)
 (N 9°40'00"E)(R1)

Sherman Homes
 Parcel Area 14,490 s.f.

Lot 21
 Parcel Area 14,490 s.f.

Book G, Maps 5
 R=1467.20'(R1)
 A=109.56'(C)(R1)

NOTE: RADIUS POINT FOR REAR LINE ESTABLISHED BY DISTANCE ~ DISTANCE INTERSECTION FROM FOUND MONUMENTS

L-1 ~ N 89°16'00"E (R1) 448.35'(C)(R1)

CURVE	RADIUS	LENGTH	DELTA	CHORD	CH. BEARING
C-1	725.00'(R1)	89.84'	7°05'59"	(7°06'00")(R1)	89.78'(R1)
C-2	1467.20'(R1)	106.90'	4°10'28"	(4°10'16")(R1)	106.87'(106.79')(R1)
C-3	1467.20'(R1)	109.56'	4°16'43"	(4°16'32")(R1)	109.54'(109.46')(R1)
C-4	1467.20'(R1)	91.26'	3°33'50"	(3°33'42")(R1)	91.25'(91.19')(R1)

LEGEND

- ~ found monument as indicated
- ∅ ~ set 5/8" bar with 2" alum. cap stamped TAHOE BASIN LAND SURVEYING, THOMAS C. BUSWELL LS 5886, unless otherwise indicated
- (C) ~ calculated as per record indicated
- (R1) ~ record per Mckinney Shores Book "G" Maps, Page 25.

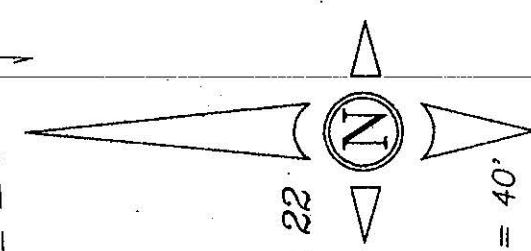

SCALE 1" = 40'

fd. 1/2" bar, no tag (R1)
 BASIS FOR PRORATE

R=1467.20'(R1)
 A=91.26'